



Eden Valley Storage Shed:

1. Preparation of the worksite; add 1 to 2' of fill including leveling of area
2. Pour concrete footings
3. Concrete side walls 4 feet high (all the way around) with 18' opening for big door and opening for walk-in door; 2' wide x 4' tall stub wall with channel on either side of big door at 90 degrees.
Note: stub walls to inside if sliding doors and to the outside if overhead door.
4. Concrete Apron in front of big door 18' x 7' and concrete landing in front of walk-in door extending 1' into the building.
5. Support Post and trusses every 10 feet across length and width
6. Brace runners every 13.3 ft across width on trusses
7. Electrical panel with 100 Amp service
8. 2 rows of 4 Lights placed on brace runners
9. 2 sets of outlets placed on each long side (four total)
-Duplex GFCI outlets
10. Double sliding exterior door placed on the short southeast side
11. Walk in door on the long side northeast corner with deadbolt lock
12. 1:12 pitch roof
13. Girts; typically 2' on center
14. 26-gauge roof and wall sheeting

Alternate #1

- Sliding exterior door replaced with overhead door with electric motor

Alternate #2

- Extend length from 40'x60' to 40'x80'

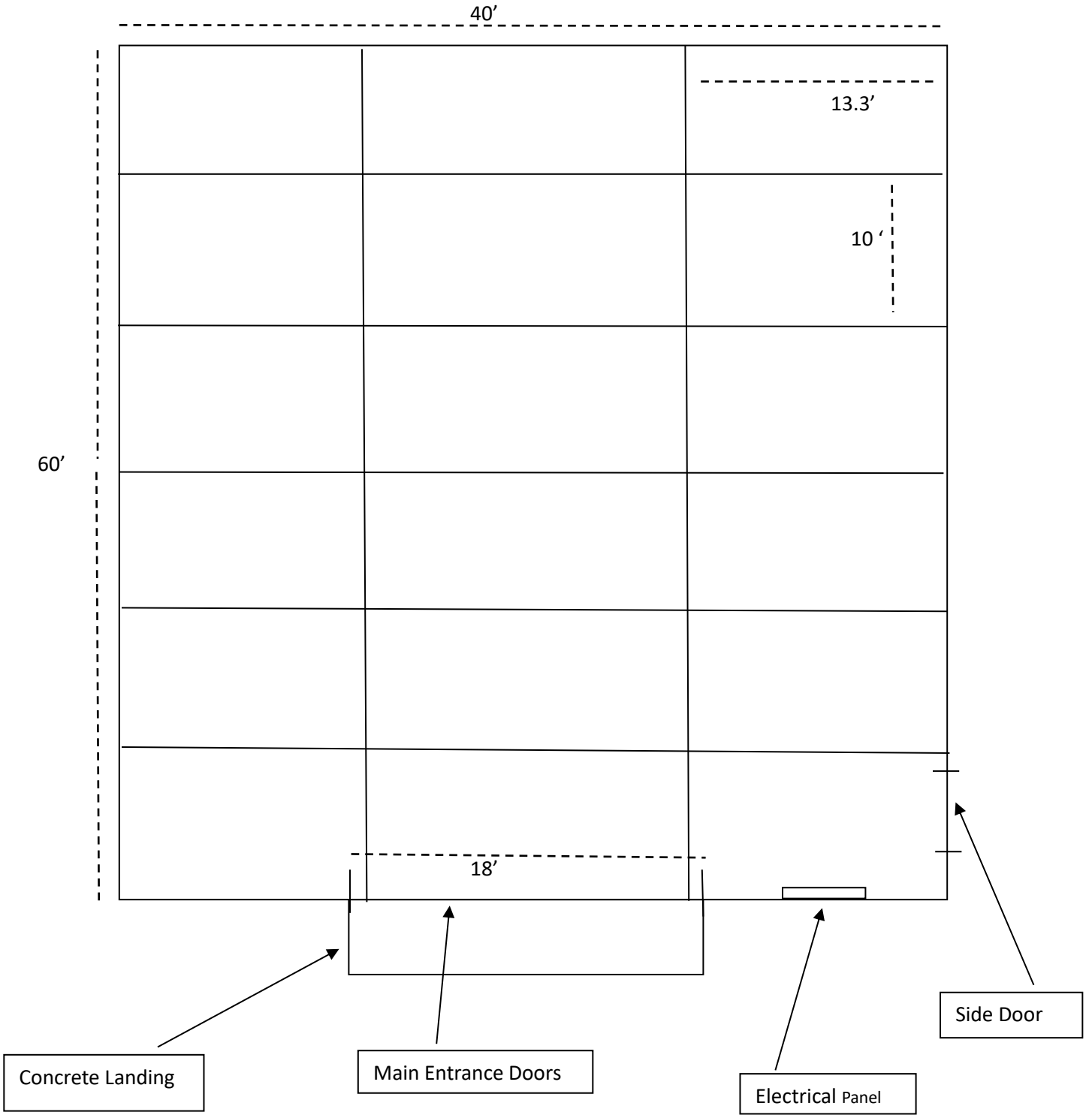

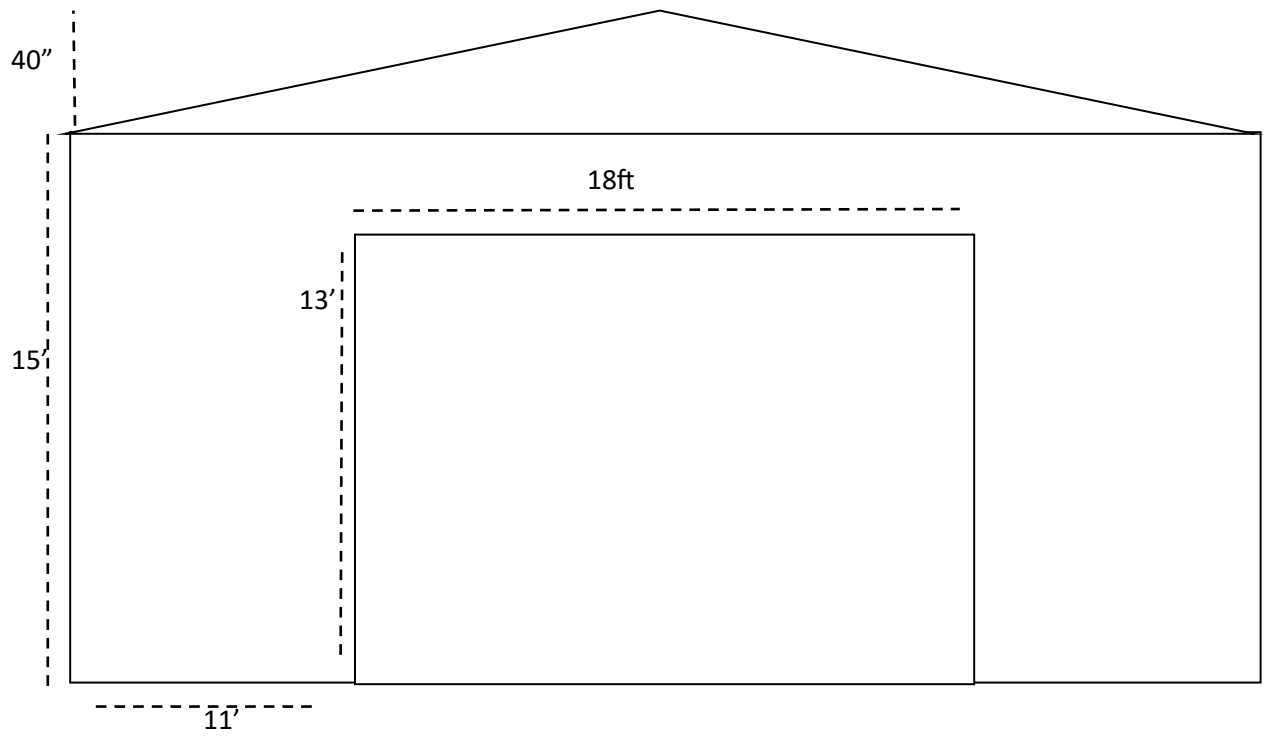

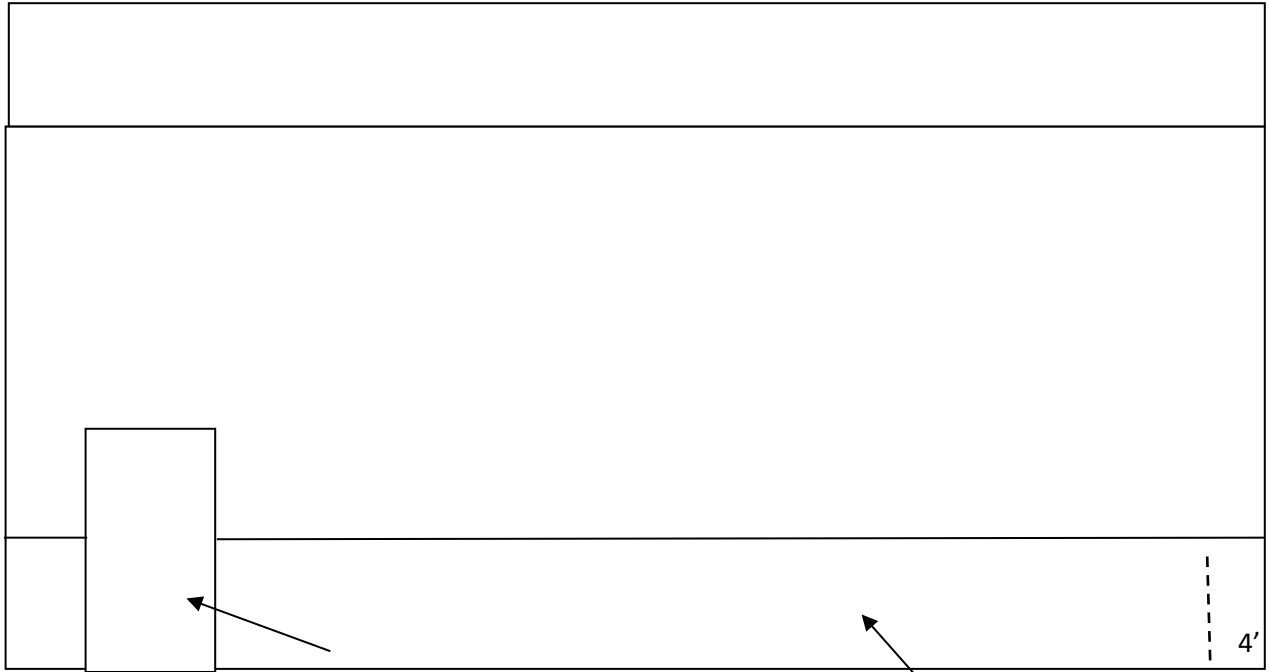

Side Door

Concrete Side

4'